

TUFFY

Refrigerated Buildings using Structural Insulated Panels (SIPs)

FOOD PROCESSING



FREEZERS



COOLERS





TUFFY

Pre-Engineered Buildings

TUFFY™ features structural wall modules utilizing expanded polystyrene foam laminated to plywood, fiberglass-reinforced plastic, or aluminum faces to assure a tight energy-efficient facility.

TUFFY structures are cost-effective because we combine exterior finish, insulation core, interior finish, and vapor barrier into a complete structural insulated panel.

EPS is the leader in designing and supplying food processing structures because we combine the coolers/freezers finishes and the offices into a cost effective, energy-efficient design.

Where is the structural steel?

It's not needed! The wall panels provide the strength needed to carry roof loads.

Since 1981—Our years of experience manufacturing insulated panel systems for cold storage and pre-engineered building packages stands behind TUFFY.

Due to the unique strength characteristics of the TUFFY wall panel system, no structural steel is required for the TUFFY building. The structure is built into the factory insulated panel.

The TUFFY building has a high tolerance to temperature extremes. TUFFY meets the requirements of national code authorities.



Innovative Foam Core Construction

Structural Wall Panels eliminate the need for structural steel frames.

Substrates of plywood laminated to an expanded polystyrene core with an ICBO approved moisture-resistant adhesive.

Aluminum facing with painted stucco embossed texture. Surfaces are USDA accepted and maintenance-free.

Fiberglass-Reinforced Plastic (FRP) also available for interior surface.

Up to R-40 expanded polystyrene core—the earth friendly insulation.

Lasting R-Value with no loss of insulation value over time due to moisture, slumping or outgassing.



*EPS Combines all the ceilings, coolers and USDA-accepted finishes with engineered details and at a competitive price.
-Welcome Meats
Welcome, Minn.*

Cooler and Freezer Construction

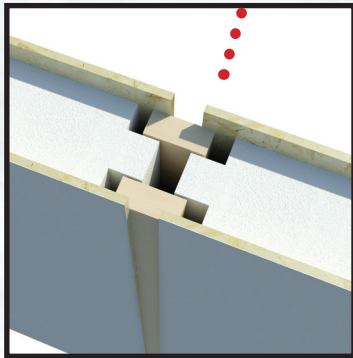
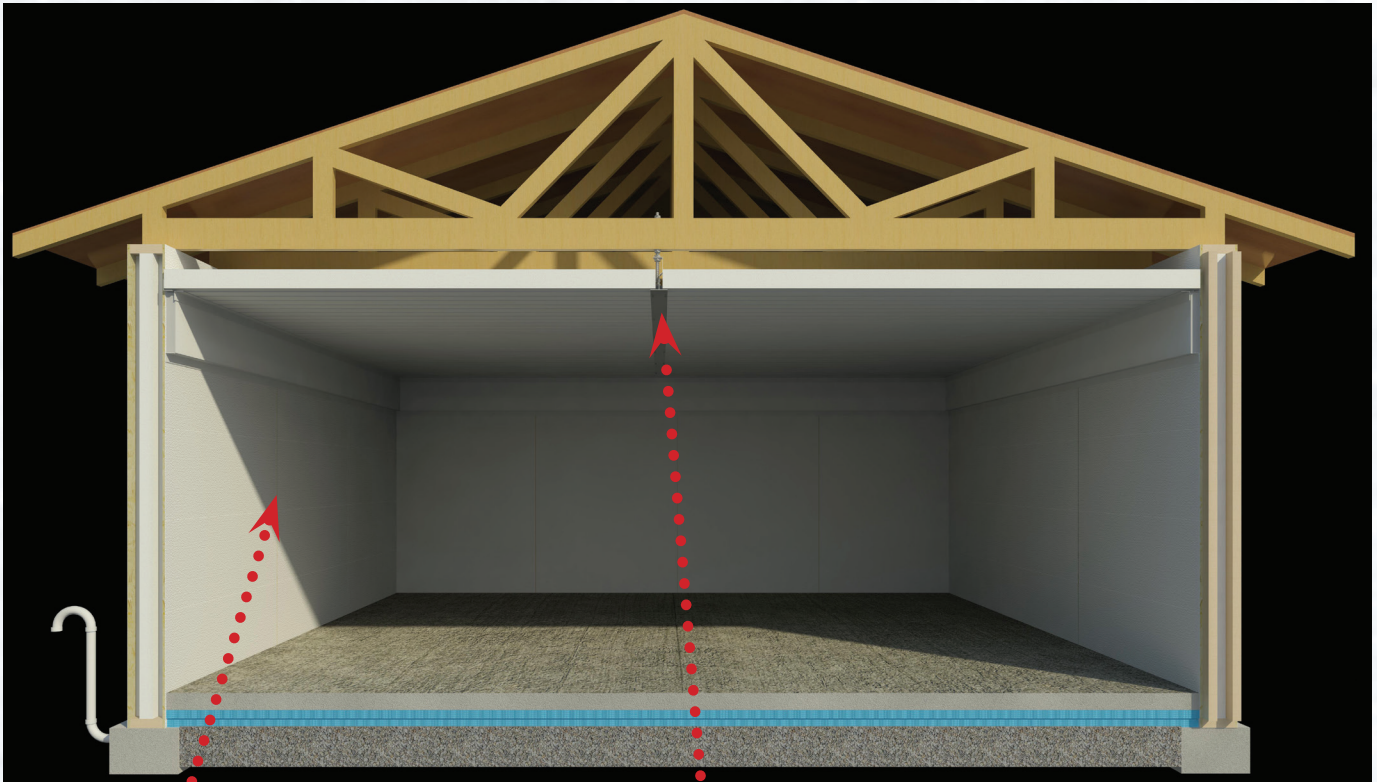

Aluminum facing with painted stucco embossed texture. Surfaces are USDA-accepted and maintenance free.

Expanded polystyrene core—the earth friendly insulation.

Double 2X4 splines with a foam to foam connection so we get no thermal bridging as you would in conventional construction.

Substrates of plywood laminated to an expanded polystyrene core with an ICBO approved moisture-resistant adhesive.

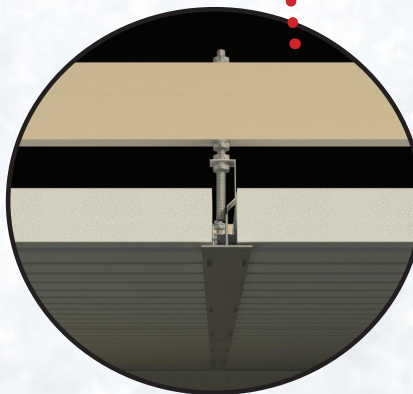

Frost Ribbon provided in freezers to keep warm air from migrating down the walls and creating condensation.

Vapor Barrier

Aluminum facing with painted stucco embossed texture. Surfaces are USDA-accepted and maintenance free. FRP facing available for interior.

Ceiling T-Bars are 3" wide and run 8' on center. Ceiling panel joints are foam filled and sealed to create a vapor barrier.

Lasting R-Value: No loss of insulation value over time due to moisture, slumping or outgassing.

Environmentally Safe: No CFC's harmful to the earth's ozone layer. No formaldehyde and no carcinogens that can be ingested.

Custom Cooler and Freezer Doors

Door Features

- Extra heavy duty construction
- Rigid foam insulation
- Cam lift hinges
- Compression style gasket
- Chrome hardware with stainless steel fasteners
- Thermally broken threshold
- Extruded aluminum frame
- Safety inside release handle
- Double run of self-regulating heater cable for freezers
- Meets USDA requirements



EPS 4' wide custom freezer door



Options

- Kick Plate
 - Smooth stainless steel
 - Aluminum diamond plate
 - Galvanized seel

Standard Door Sizes

- 4'0" x 6'8"
- 3'6" x 6'8"
- 3'0" x 6'8"
- 2'6" x 6'8"

EPS can supply many custom sliding and pass-through doors.



Food Processing



Pre-engineered and Designed to meet your needs

- Industry innovation
- USDA-accepted finish
- Cold climate controlled



Interior freezer and suspended ceiling.



Floor supported overhead rail.



USDA-accepted processing finishes



Complete Packages

Create your building system!

Combine your office, retail, food processing and freezers into one fully-engineered envelope.

- Building Code: Meets building code requirements without sprinkler systems
- USDA-accepted
- Clear Span: no interior columns required for buildings up to 100' wide. No exposed purlins or girts. Allows for maximum flexibility of space usage.
- Faster construction: Erects in days, not weeks. Saves labor and financing costs.
- Totally engineered: Structural integrity and stamped by our on-staff registered engineers.
- Guaranteed panel R-Values—not compressed promises. Rigid EPS core is not affected by moisture and has no gaps to allow air infiltration. R-Values of R-19, R-26 or R-33.



TUFFY

*Simply better
Buildings!*



TUFFY is the right choice for:

- Food processing
- Freezer buildings
- Cooler buildings
- Retail outlets
- Controlled environments
- USDA-accepted finishes

INDEPENDENT AUTHORIZED DEALER:



epsbuildings.com

Energy Panel Structures

603 N. Van Gordon Ave., Graettinger, IA 51342

BBL Construction Fingerlakes Construction
Perryville, MO Clyde, NY

Phone: 800-967-2130

100% Employee Owned—100% Committed to Quality



REV0114